

Prime Retail Location

451 Station Avenue, South Yarmouth, MA



PROPERTY HIGHLIGHTS:

- HIGH VISIBILITY LOCATION
- 6,580+/- SQ FT
- NATIONALLY TENANTED PLAZA
- AMPLE PARKING
- NEAR LIGHTED INTERSECTION
- CLOSE PROXIMITY TO EXIT 8 ON THE MID-CAPE HIGHWAY
- CLOSE TO MAJOR SHOPPING CENTERS

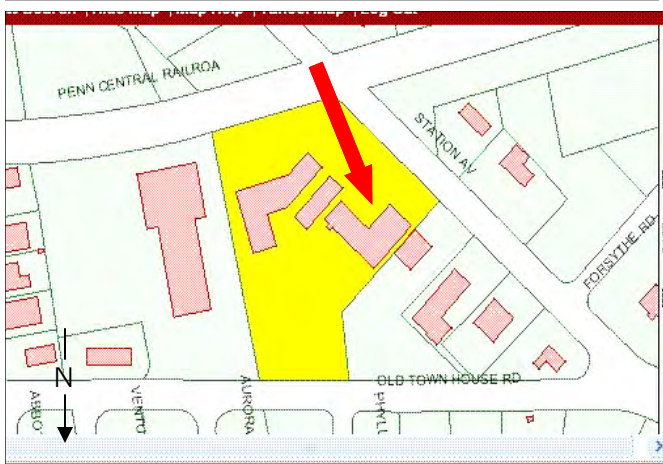

Subject Property +/- 6,580 Sq. Ft.

Wendy's

Station Ave Convenience

CVS Pharmacy

Sweet Tomatoes Pizzeria

Asking \$18.00 Per Foot N-N-N

For more information about this opportunity please contact

Brad Kuhrtz

Commercial Realty Advisors, Inc.

Commercial Realty Advisors, Inc.

Real Estate Investment Brokerage Company

222 West Main Street

Hyannis, Massachusetts 02601

Tel: 508-862-9000

Fax: 508-862-9200

www.comrealty.net

451 Station Avenue, South Yarmouth, MA

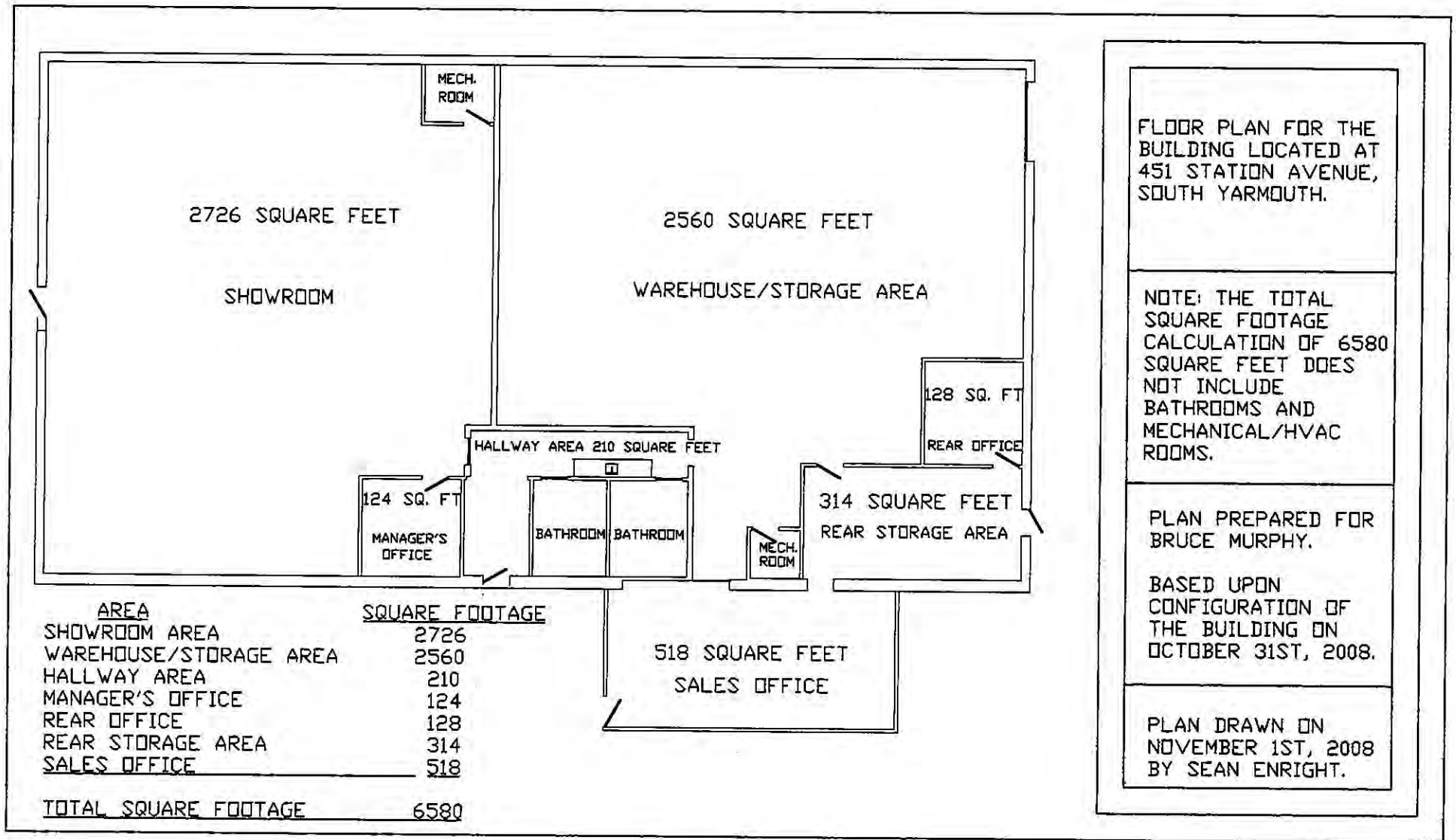

451 Station Avenue, South Yarmouth, MA



Available Space



Available space seen from Station Avenue



Available space seen from plaza entrance



Available space and adjoining tenant seen from plaza entrance



CVS Pharmacy (Just opened)



Wendy's seen from Old Townhouse Road. This is the second plaza entrance (with CVS in the background).

451 Station Avenue, South Yarmouth, MA

